

**JAW DIMENSIONS AND MOUNTING CENTRES**

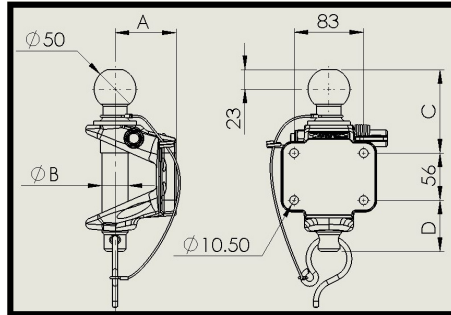

Model	A	B	C	D
DB208356	73	ø32	99	61
DB218356			53	86
DB248356				62

**Bradley Doublelock Ltd**

Victoria Works  
Victoria Street  
Bingley  
West Yorkshire  
BD16 2NH

General : 01274 560414  
Sales : 01274 516760

Sales Enquiries : sales@bradleydoublelock.co.uk  
Web : www.bradleydoublelock.co.uk

**FITTING, USAGE AND MAINTENANCE INSTRUCTIONS.**  
**IMPORTANT** please read carefully.

Part No.	18282
Issue	00

Part No.	Approval No.	Class	'D' Value	'S' Value	Max Gross Towing Vehicle Mass	Max Gross Trailer Mass
DB208356 DB218356 DB248356	E11 01-10762	A50 X/S S S	30.95 kN	350 kg	32000 kg	3500 kg

**RESPONSIBILITY !!**

Accessories which are not properly fitted can be dangerous, with the potential for serious injury or damage. It is recommended that all accessories are fitted and maintained by professionally competent persons.

It is the responsibility of the vendor to ensure compatibility between all approved products i.e. ensures that the towing vehicle, towbar and coupling device have the correlating S-Value, D-Value, and requisite Class designation. If in doubt, contact the manufacturer of the respective product.

Only use Dixon Bate spare parts such as spare pins, "R" and pig tail clips etc.

If in doubt contact your supplier or Bradley Doublelock Ltd on 01274 560414 / 516760

**EU Approved Products – Legal Requirements**

Only fit EU type approved products to European type approved towing brackets (see approval No. above) and ensure that their S & D values meet the requirements of your towing vehicle and trailer combination. When fitting an accessory whether EU approved or not to a non-EU type approved towing bracket refer to the towing bracket manufacturer's instructions and adhere to the towing capacities as stated in the vehicle manufacturer's handbook.

Height requirement for the fitting of the unit is 350 - 420 mm from the ground when fully laden.

**Warning !!**

Before fitting ensure that all bolt/nut/washer contact surfaces are free from excess paint, dirt, under seal, weld splatters etc.

**Warning !!**

When fully tightened, ensure that the equivalent of half the bolt diameter protrudes through the nut. It is imperative to use fasteners with vibration proof washers under the nut. Unless self locking nuts are used in which case plain washers may be used.

Model	Bolt Size	Minimum Bolt Grade	Minimum Nut Grade	Recommended Torque Only Use calibrated Torque Wrench
DB208356 DB218356 DB248356	M10 X 1.50 Pitch	8.8	8	56 Nm

DB208356

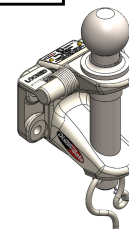

DB248356

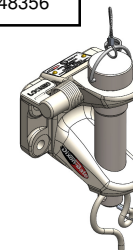

DB218356

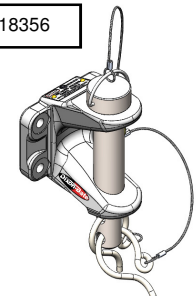

**USAGE, MAINTENANCE, SAFETY. IF IN DOUBT CONTACT Bradley Doublelock Ltd**

Using a calibrated torque wrench check tightness of all bolts/nuts initially after the first 500 miles (800 km) of towing and then at 1000 miles (1600 km) intervals.

Check regularly all moving parts for signs of wear and faulty operation. Replace if necessary. Use only genuine parts. Grease moving parts regularly and check for wear. All mating faces should be cleaned before use and lubricated regularly. Check ball size before use it should not be less than  $\varnothing 49.5$  mm. The pin should not be worn by more than 10% of its original cross sectional area. If either are worn to this extent then they must be replaced before use. Similarly the head or eye should be checked for wear before use. Refer to manufacturers instructions.

Note : Eye shaft compatibility. ( 40 / 50mm I/D Cross section no greater than 29.4mm )

Note : Non of the units will accept a 76mm I/D NATO STANDARD eye shaft or a 40DIN.

**Operating Instructions DB218356**

**Coupling using eye-shaft and pin. Keep away from coupling area when using prime mover to couple the trailer**

Withdraw Pig tails, R Clips from the bottom of the pin.

- Position the eye-shaft in the jaw by using the jockey wheel to set its height and manoeuvre into place. Always ensure the handbrake is used and that the trailer is not free to roll uncontrollably.
- Locate the pin so that it passes through the top flange of jaw, eye-shaft and bottom flange of jaw.
- Once in place and locked. Replace the Pig Tails, R clips in the two holes provided.
- Fit secondary couplings to towing vehicle before removing hand brake, chocks.
- Connect lighting and check functionality before towing.

**Operating Instructions DB208356—DB248356**

**Coupling using eye-shaft and pin. Keep away from coupling area when using prime mover to couple the trailer**

**Warning ! The above units are fitted with a primary locking pin which is operated using a powerful torsion spring and care must be taken when operating it.**

- Withdraw Pig tails, R Clips from the bottom of the pin.
- Rotate the primary lock through 180° from locked to free position and hold in place whilst the pin, ball and pin are withdrawn from the jaw.
- Caution the locking pin will flip back to locked position when released due to the torsion spring.
- Position the eye-shaft in the jaw by using the jockey wheel to set its height and manoeuvre into place. Always ensure the handbrake is used and that the trailer is not free to roll uncontrollably. Use chock if necessary. Use the prime mover to position the eye if at all possible.
- Once the eye-shaft is in place rotate the primary lock from its locked position to its free position and hold.
- Locate the pin, ball-pin in the jaw orientating it so that the groove in the pin is facing away from you. Ensure the pin, ball pin passes through the top flange of jaw, eye-shaft and bottom flange of jaw. When the pin, ball pin is correctly positioned then the primary locking pin will flip to its locked position due to the torsion spring but not until the groove in the pin is correctly located.
- If necessary keeping your hand and fingers away from the locking pin rotate the pin, ball pin in the jaw and once the pin and groove are aligned the locking pin will snap into its locked position.
- Once in place and locked. Replace the Pig Tail, R clip into the hole provided.
- Fit secondary couplings to towing vehicle before removing hand brake, chocks.
- Connect lighting and check functionality before towing.

**Operating Instruction.**

**Uncoupling using eye-shaft and pin.**

**Warning !!**

**Ensure that the trailers hand brake is on and that the trailer is chocked if necessary before removing the pin from the jaw. Leave the secondary coupling in place until you are satisfied the trailer is under control. To avoid damage always remove lighting socket prior to pulling the vehicles apart .**

Follow the procedures described previously removing the eye-shaft from the jaw rather than positioning it. Use the prime mover to disconnect the trailer from the jaw if at all possible.

To avoid accidents and prevent loss. **Always replace the pin into the jaw and secure using the primary lock, pig tail and or 'R' clips if fitted.**

Model	Spare Pin & Wire Kit No.
DB218356	KIT169
DB208356	KIT170
DB248356	KIT185
Model	Locking Handle Kit No.
DB208356—DB248356	KIT173

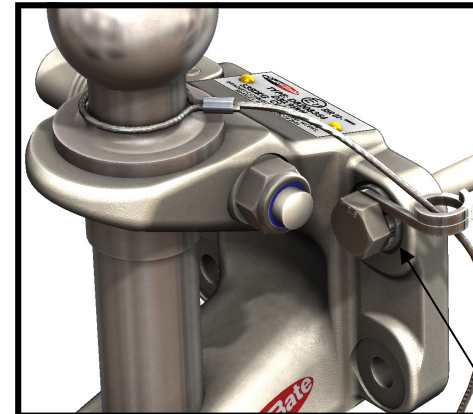

**TO ENSURE CORRECT BOLT SEATING ENSURE AN M10 PLAIN WASHER IS MOUNTED UNDER THE WIRE RETAINING CLIP AS SHOWN.**